



APPLICATION FOR STORM SHELTER PERMIT
CITY OF MIAMI, OKLAHOMA

Date: _____

Please Note: An incomplete permit application can delay issuance

1. Owner Name, Address & Phone:

Phone # _____

2. Contractor/Builder Name, Address & Phone:

Phone # _____

3. Job Location Address: _____

4. Is Storm Shelter/Safe Room certified?: Yes _____ No _____ \$ _____
If yes, please check all that apply: Cost of Storm Shelter

FEMA 361 _____ FEMA 320 _____ ICC 500 _____

5. Construction Documents, plans & specs attached? ___Yes ___ No

6. Do you have any questions? ___Yes ___No (If Yes, we will contact you to discuss any questions you may have.)

(Signature of applicant) I understand the City of Miami is not responsible for the design,
construction or testing of any Storm Shelter or Safe Room.

PLEASE ALLOW 5 BUSINESS DAYS FOR COMPLETED PERMIT APPROVAL
PLEASE CALL 918-961-8938 FOR INSPECTIONS

FOR STAFF USE ONLY

Approved by: _____
(City Inspector) (Date) (Permit No.)

Not Approved by: _____
(City Inspector) (Date)

Attachment A

PLAN DRAWING

Please draw a site plan indicating location on property (See sample on Attachment B).

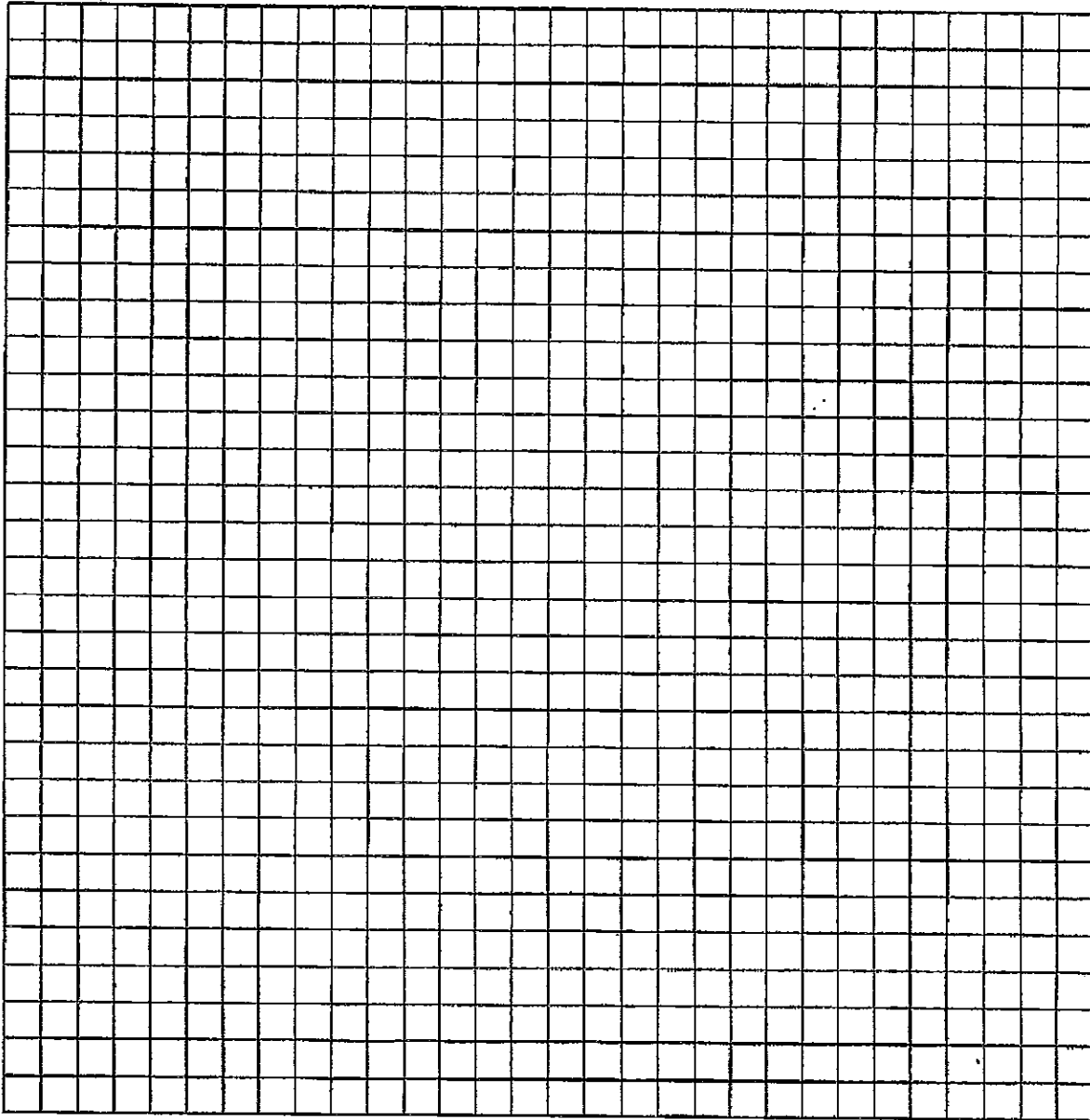

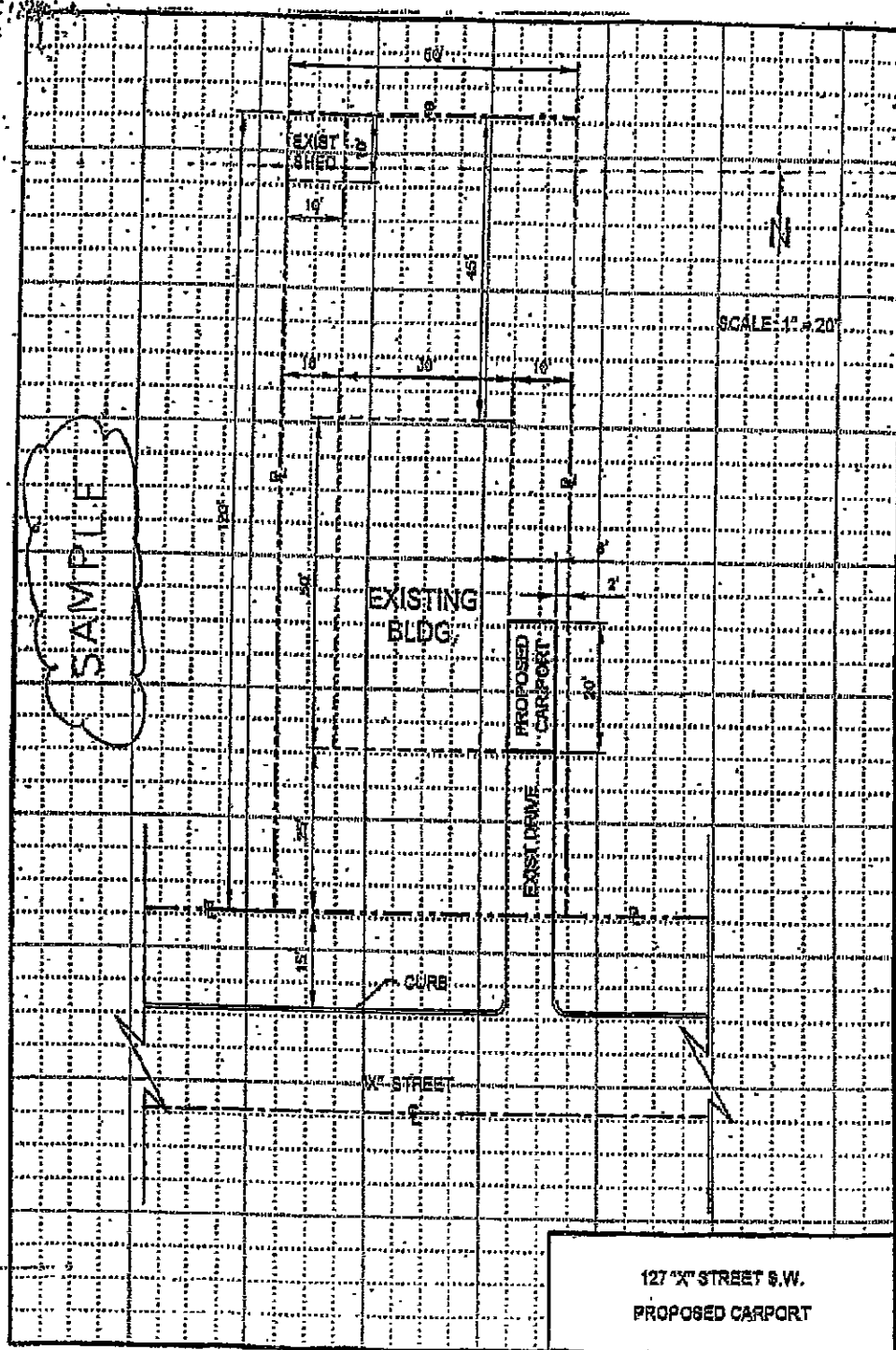



Engineering Dept.
129 5th NW
PO Box 1288
Miami, OK 74355
918-541-2329

Request for Floodplain Determination

Date: _____

Name of Person Requesting Information _____

Name of Company or Organization _____

Address _____

Telephone Number _____

Address of property for which floodplain determination is requested: _____

Please check box for preferred return of determination:

By E-mail: E-mail address _____

By Fax: Fax # _____

By Return mail

By Picking determination up at Engineering Office, 129 5th NW, Miami, OK 74354

PLEASE ALLOW 3 BUSINESS DAYS FOR STAFF TO COMPLETE DETERMINATION

NOTE: This Federal Flood Zone determination is based on the Flood Insurance Rate Map for the City. This letter does not imply that the referenced property will or will not be free from flooding damage. A property not in a Special Flood Hazard Area may be damaged by a flood greater than that predicated on the FIRM or from a local drainage problem not shown. This letter does not create liability on the part of the City of Miami, or any officer or employee thereof, for any damage that results from reliance on this determination.

.....
For staff use only:

Date Received: _____ Longitude/Latitude of Property _____

Property, as marked on attached map, is located in Flood Hazard Area: _____

Property, as marked on attached map, is NOT located in Flood Hazard Area : _____

Sources of information:

_____ Flood Insurance Rate Map (FIRM) for City of Miami Panel Number _____.

Effective Date: August 10, 2010.

_____ Letter of Map Change

Effective Date: _____

_____ Flood Insurance Study (FIS), August 10, 2010.

Floodplain Administrator

Date

Instructions

1. Fill out application
2. Turn application into one of the following ways:
 - Engineering Office at the Civic Center, 129 5th NW, Miami, OK 74354
 - By mail to City of Miami, Engineering Office, PO Box 1288, Miami, OK 74355
 - E-mail to mfurnas@miamiokla.net or tasbell@miamiokla.net
 - Fax to 918 542-3539
3. Applications will be reviewed within 3 business days.
4. Application will be returned to customer with floodplain determination and map.

Additional Information on-line:

- To view online go to: <http://www.floodsmart.gov>
- To view property online go to: <http://fema.gov>
 - Pick Disaster & Maps
 - Pick Map Service Center under maps
 - Select Product Catalog (red tab)
 - Pick Effective FIRMs/FHBMs
 - Select OKLA
 - Select OTTAWA
 - Select MIAMI
 - Select current FEMA issued maps (you will have to find your address on one of these maps.

Definitions:

- **Base Flood**--A flood having a one percent chance of being equaled or exceeded in any given year.
- **Zone**--A geographical area shown on a Flood Hazard Boundary Map or a Flood Insurance Rate Map that reflects the severity or type of flooding in the area.
- **Zone A** – No Base Flood Elevations determined
- **Zone AE** – Base Flood Elevations determined.
- **Zone AH** – Flood depths of 1 to 3 feet (usually areas of ponding); Base Flood Elevations determined.
- **Zone X** – Areas of 0.2 % annual chance flood; areas of 1% annual chance flood with average depths of less than 1 foot or with drainage areas less than 1 square mile; and areas protected by levees from 1% annual chance flood.